

# The Great Aussie Fungi Quest

## Field Guide

### How to describe my fungus

Prepared by Fungimap

Welcome to the largest fungi bioblitz in Australia's history, a collaboration between Fungimap and QuestaGame!



The Great Aussie Fungi Quest uses citizen scientists to help map the distribution of the fungi 'in fruit' during a single month across Australia and identify those that are easily recognisable from your photos.

Fungi make up a whole Kingdom of Life that is critical to our living planet. Without fungi, forests would not exist, we would not exist. And yet it is a scientific frontier largely unexplored.

So, whether you live on the coast or in the desert, your photographs will help increase the body of knowledge we have of fungal species in Australia.

**To participate in Fungi Quest, take 4 photos of any fungus, lichen or slime mould you find between 1 May and 31 May 2023.**

**Upload them via the QuestaGame or iNaturalist apps and they will aggregate into the Great Aussie Fungi Quest live site.**

## PHOTOGRAPH YOUR MUSHROOM

**Above**



**Side on**



**The underside**



**The environment showing vegetation  
(5 – 10 steps back)**



## YOUR LOCATION

If you feel comfortable, show the location of your specimen on the [QuestaGame](#) or [iNaturalist](#) apps. This helps us accurately map the fungi in Australia.

## INCLUDE NOTES

1. What does my fungus look like - does it have gills or pores, or is it a cup or a coral, etc?
2. How big is it?
3. What colour is it?
4. What is the surface like? Is it fuzzy, slimy, dry, smooth, spiny, hairy, scaly, waxy etc.?
5. Does it have a stipe (stem) and if yes what does that look like?
6. What is the substrate (growing out of soil, wood, leaves etc)?
7. What does it smell like? Does it smell sweet, almondy, nutty, citrusy, fishy, oniony, peppery or like something is rotting?

## GROUPS OF FUNGI

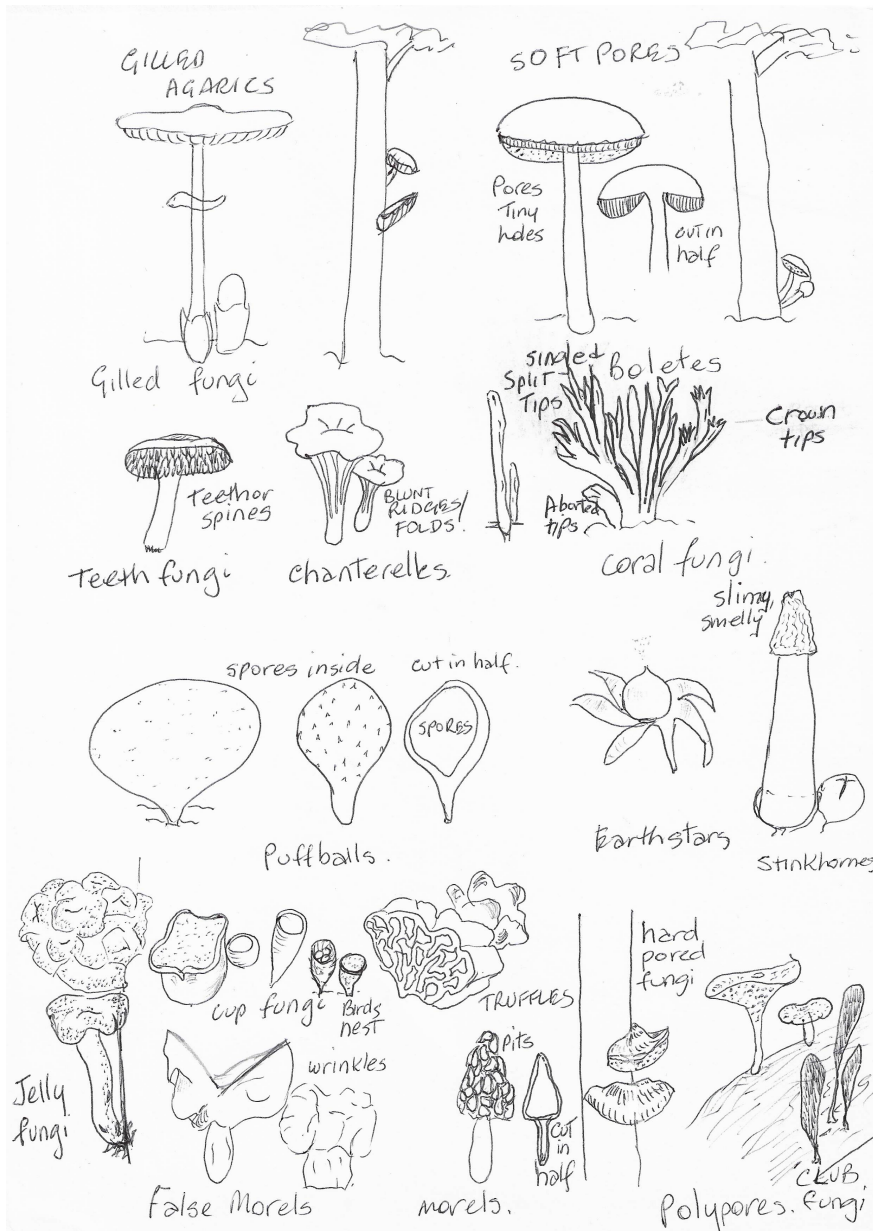



### Pileus (Cap) Shape

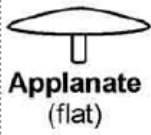

**Applanate**  
(flat)

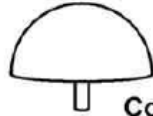

**Convex**  
(rounded)



**Conical**  
(cone like)



**Campanulate**  
(bell shaped)



**Infundibuliform**  
(centrally depressed)

### Pileus apex (top)



**Umbonate**  
(central raised bump)

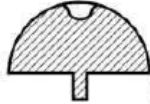

**Umbilicate**  
(central indent)

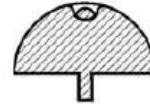

**Papillate**  
(pimple in indent)

### Pileus surface



**Glabrous**  
(smooth)



**Pubescent**  
(finely hairy)

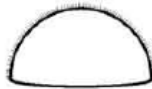

**Velutinous**  
(like velvet)

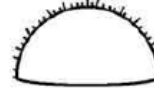

**Villose**  
(coarsley hairy)



**Fibrillose**  
(radiating fibres)

**Squamulose**  
(with scales)



**Areolate**  
(breaking into patches)

### Pileus margin (cap edge)



**Entire**  
(smooth)

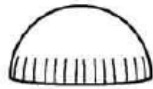

**Striate**  
(lines at edge)

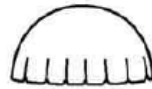

**Tuberculate**  
(furrowed)



**Plicate**  
(pleated)



**Rimose**  
(splitting)

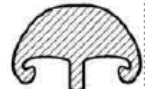

**Inrolled**

### Lamellae (gills) attachment

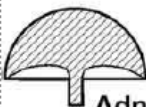

**Adnate**  
(right angled)



**Adnexed**  
(acute angle)



**Emarginate**  
(very acute)

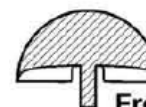

**Free**  
(not reaching stem)

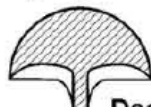

**Decurrent**  
(running down stem)



**Sinuate**  
(notched)



**Arcuate**  
(arched)

### Lamellae arrangement

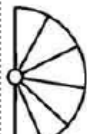

**Regular**  
(all gills reach stem)



**Intercalated**  
(with some short gills)

in one series  
in two series

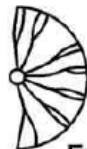

**Furcate**  
(splitting)



**Anastomising**  
(cross gills present)



**Hydroid**  
(with teeth)

**Pores**  
(sponge like)



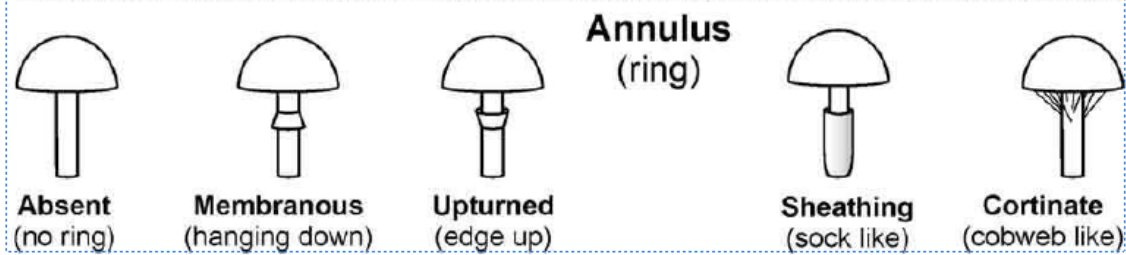
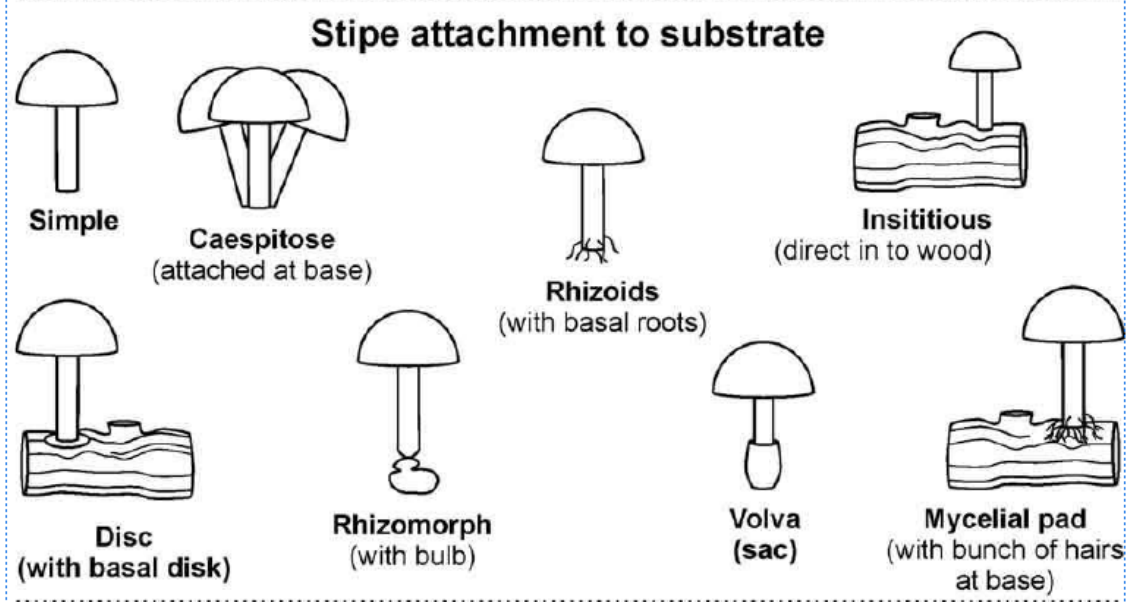
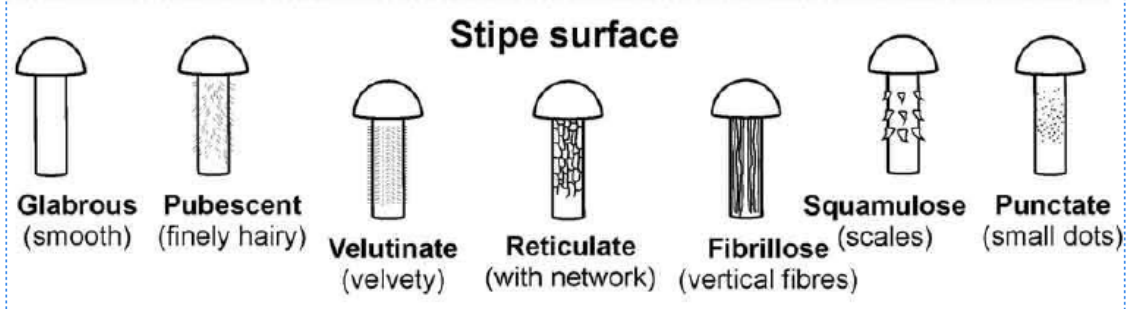
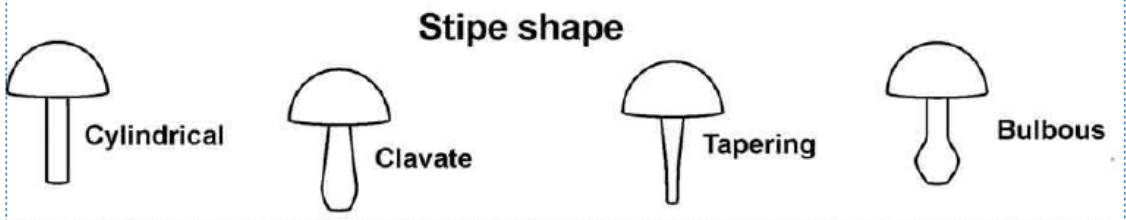
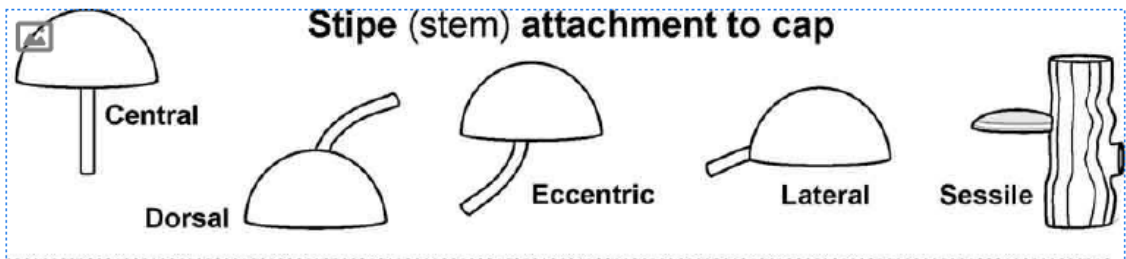

Illustrations by Will Smith, Queensland Herbarium